

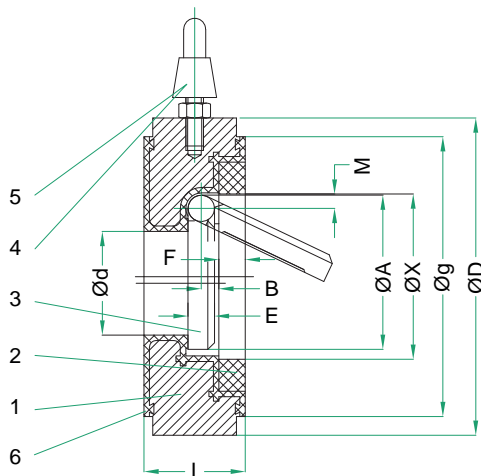

Features / Design

Lined Valves - Series 74SL / Wafer Swing Check Valve

- TFV lined check valves come in several forms, all of which fulfill the same basic purpose, namely to allow forward fluid flow, but to minimize backwards flow. They prevent the back-flow of liquids in pipelines, prevent siphoning of pumps and eliminates pump impeller rotation in opposite direction due to back-flowing media. Generally check valve is automatically working. Under the pressure function of one direction flow, the disc opens, while when the liquid backflows, the valve will cut the flow.
- TFV 74SL Series - fully lined wafer swing check valve, is of two piece construction with only one moving part, ideal for use in totally lined piping systems in corrosion applications. The valve can be mounted horizontally or vertically with upward flow.
- It can sustain any corrosive medium in addition to the "molten alkali metals & fluorine elements". It is ideal for chlor-alkali & organic chemicals industry, metal & mining, nitrogen & phosphatic fertilizers, petroleum refining, pharmaceutical, etc.
- Design & Manufacture Standard: API 594.
- Ends Wafer according to ASME B16.5.
- Face to Face: API 594.
- Lining Thickness: 3 to 5 mm.
- Inspection and Test Standard: API 598.
- Liner Inspection: Spark test 15 Kv.
- Temperature Range (°C): PFA (-30 to 200), FEP (-30 to 150), PO (-10 to 80).

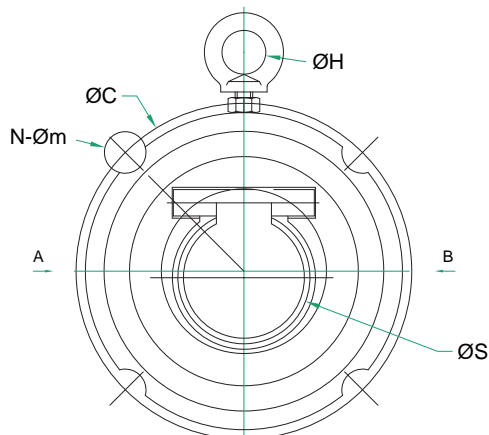

Material List

NO.	PART NAME	MATERIAL
1	BODY	A216 WCB / A351 CF8M
2	RETAINING RING	PTFE
3	DISC	CF8 + PFA or Solid PFA
4	SUSPENSION RING	A216 WCB / A182 F304
5	NUT	A216 WCB / A182 F304
6	BODY LINER	PFA

NOTE: Material list as example, other materials and liners available. TFV lined wafer swing check valves are available as per the needs of applications in additional sizes and other than standard materials. Please contact us.



Dimensions (inches)

SIZE	L (in)	ØD (in)	ØC (in)	Øg (in)	Ød (in)	N (in)	Øm (in)	ØH (in)	ØS (in)	X (in)	A (in)	B (in)	E (in)	F (in)	M (in)	CV (USgpm)	WEIGHT (lb)
2"	1.693	4.213	4.752	3.622	1.142	4	0.748	0.787	1.496	1.969	1.890	0.276	0.394	0.472	0.276	27	5.952
2 1/2"	1.811	5.118	5.500	4.134	1.575	4	0.748	0.787	2.047	2.559	2.441	0.315	0.472	0.472	0.276	34	6.614
3"	1.811	5.669	6.000	5.000	1.850	4	0.748	0.787	2.362	2.953	2.795	0.315	0.472	0.472	0.276	40	11.023
4"	2.047	7.154	7.500	6.102	2.598	8	0.748	0.787	3.150	3.858	3.425	0.315	0.630	0.551	0.512	55	14.991
5"	2.205	8.465	8.500	7.283	3.150	8	0.866	0.787	3.740	4.921	4.409	0.315	0.630	0.630	0.512	80	*
6"	2.205	9.098	9.500	8.504	3.937	8	0.866	0.984	4.528	5.787	4.803	0.315	0.709	0.787	0.866	150	24.251
8"	2.362	11.343	11.752	10.433	5.433	8	0.866	0.984	6.142	7.874	6.535	0.472	0.866	0.787	0.748	320	41.888
10"	2.677	13.787	14.252	12.795	6.890	12	0.984	1.181	7.677	9.843	8.071	0.472	0.866	0.787	0.906	540	61.729
12"	3.071	16.531	17.000	15.000	8.386	12	0.984	1.378	8.858	11.811	9.291	0.551	0.945	0.866	1.181	680	85.980
14"	3.071	18.224	18.752	16.260	9.370	16	1.142	1.378	10.236	13.780	10.669	0.630	1.024	0.866	1.575	950	143.301
16"	4.016	20.079	21.252	18.701	12.008	16	1.142	1.496	12.756	15.630	13.189	0.709	1.142	1.260	1.890	1545	198.416
20"	5.000	24.409	25.000	22.992	15.945	20	1.260	1.969	16.850	19.567	17.717	0.906	1.417	1.378	2.362	3800	363.763
24"	6.063	28.543	29.500	27.165	17.717	22	1.378	1.969	18.504	23.504	19.291	0.945	1.575	1.378	2.756	5700	562.179

NOTES: *Please consult with supplier.

Pressure Temperature Chart

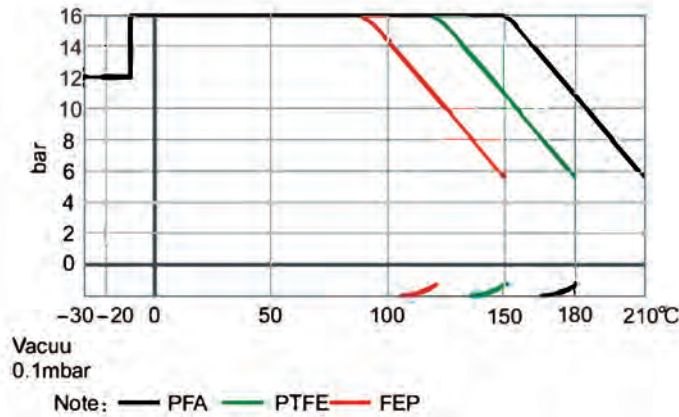

How to Order

SERIES NUMBER	MATERIAL						ENDS	CLASS	SIZE		OPERATION			
	BODY	DISC	BODY & TRIM LINER		SEAT									
74SL	2	WCB	2	WCB	P	PTFE	NONE	W	WAFER	0	ANSI 150#	02	2"	NONE
	3	CF8M	3	316SS	F	FEP				02.5	2 1/2"			
	4	CF8	4	304SS	F	PFA				03	3"			
	6	DI / CI			E	ETFE				04	4"			
					K	KYNAR				05	5"			
										06	6"			
										08	8"			
										10	10"			
										12	12"			
										14	14"			
										16	16"			
										18	18"			
							20	20"						
							24	24"						

Example:

Lined Swing Check Valve, Body DI + PFA Liner, Trim 304 + PFA Liner, Seat PTFE, Water ANSI Class 150# Size 6".

74SL64AW006

